

**SITE ORGANIZATION**

**1 Bus Loading, Pick-up/Drop-off and Parking**

- Separate bus loading, parent drop-off, and parking areas at main entry alongside Hans Ave.
- New staff parking and parent drop-off at Barbara Ave.

**2 Support Facilities**

- Expansion of existing administration offices
- Addition of a new library/media center to the existing classroom building in front of the campus
- New centrally located MUR

**3 Classrooms**

- New two-story classroom building
- New extended care classroom close to parent drop-off at main entry of the campus

**4 Kindergarten Cluster**

- Modernization of the existing classroom building to provide a kindergarten cluster

**5 Play Areas**

- Designated age appropriate play equipment
- Development of hard-court play area

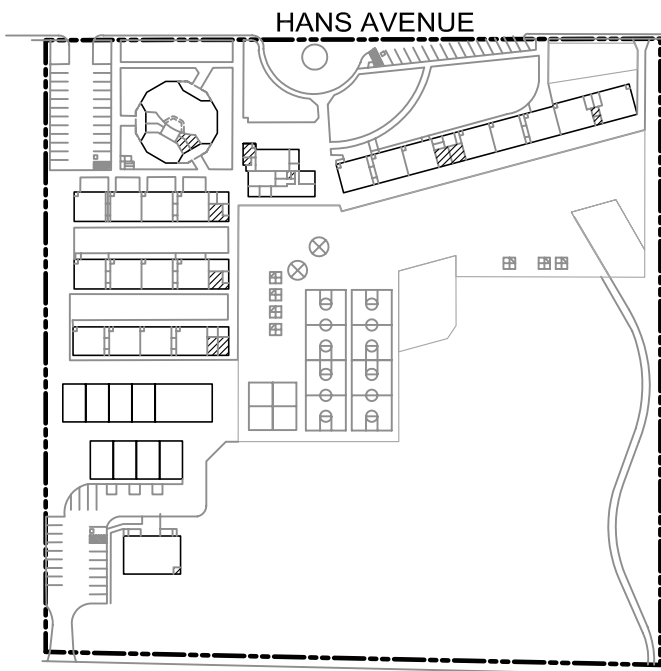

EXISTING

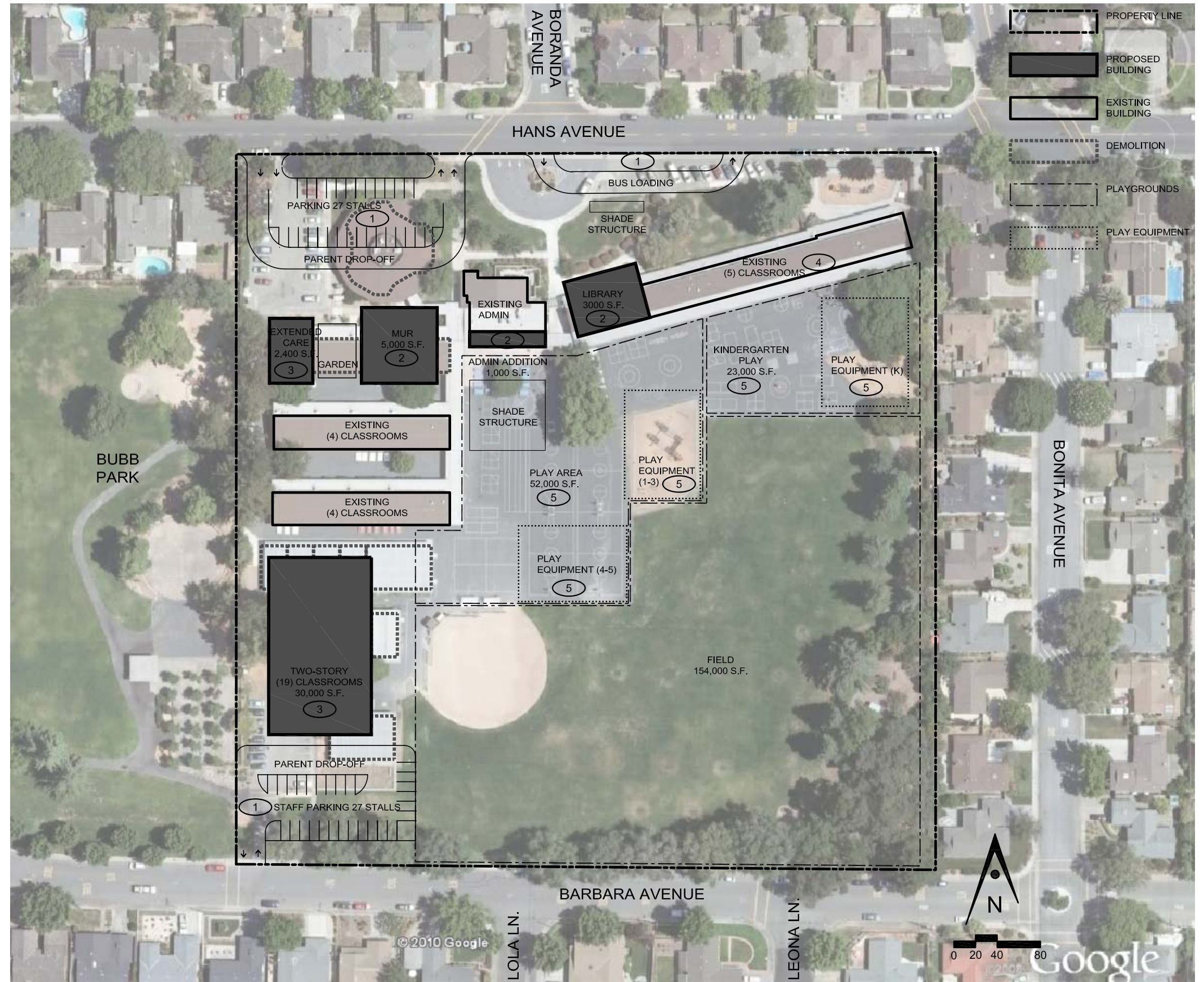

PROPOSED SCENARIO

February 18, 2010